

The Colin Lewis Suite

Dating back to the 14th century, The Colin Lewis Suite retains its medieval charm with exposed oak beams and inglenook fireplace.

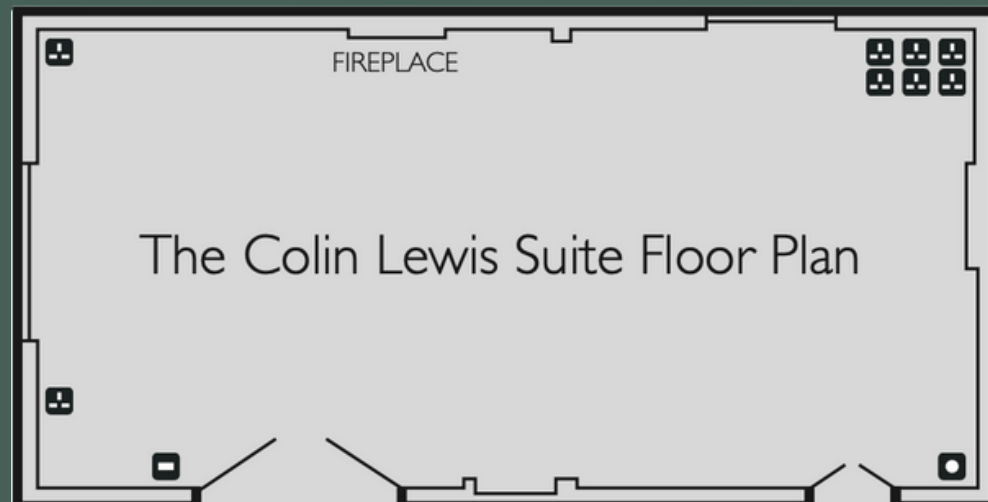

The tranquillity of the room, guarantees the conducive environment in which to work. The room is also ideal for private dining for up to 50 and has its own private bottle bar and toilets.



Capacity	Services	Dimensions
Theatre Style 65	Natural Light Y	Total Area (m ²) 63.8
U Shape 25	Blackout Possible Y	Length (m) 11
Classroom 20	PA System N	Width (m) 5.8
Board Room 30	Telephone Point 1	Ceiling Height (m) 4
Hollow Square 30	WIFI Y	Door Width (m) ... 0.78
Dinner Dance 45	TV Point 1	Door Height (m) ... 1.97
Dinner Only 50	Three Amp Socket ... 8	Floor Level First
Buffet Reception 70	Room Controlled	Obstacles None
Cabaret Style..... 35	Air Conditioning N	